B
1

SPECIFICATIONS

CONTACT RATING: 5A @120 VAC or 28 VDC (Q terminal)
 ELECTRICAL LIFE: 50,000 make-and-break cycles at full load
 CONTACT RESISTANCE: 10 m Ω max. initial @2-4 VDC, 100 mA
 INSULATION RESISTANCE: 1,000 M Ω min.
 DIELECTRIC STRENGTH: 1,500 V RMS @ sea level.
 OPERATING TEMPERATURE: -30? C to 85? C

MATERIALS

CASE - diallyl phthalate (DAP)
 Actuator - ABS ,black standard.
 Frame - Nylon (UL 94V-0) ,black
 BUSHING - Brass or Zinc , nickel plated
 HOUSING - Stainless Steel
 CONTACT AND TERMINAL - Copper alloy, silver plated

How do you build the switches you need!!

The straight terminal type , please see the (A) ;

The right angle P.C terminals, please see the (B)

(A) **R 8 0 1 5** - **R 1 1** - **2** - **C** **Q** - **E** - **S 2 0**

Switches Function				Actuator	Actuator Color	Frame Color	Termination	Vertical support Bracket
R8015	SP	R8017	DP	on-none-on	R11	1 white	(none) black (std.)	B solder lug
R8015A	SP	R8017A	DP	on-none-(on)	P21	2 black(std)	1 white	C P.C 1.27width
R8016	SP	R8018	DP	on-off-on	P13	3 red	the standard color of frame is black, the code is "blank"	D Quick connect
R8016A	SP	R8018A	DP	(on)-off-(on)	P23	4 orange		D1 wire wrap 19.05
R8016B	SP	R8018B	DP	on-off-(on)	R15	5 yellow		D3 wire wrap 10.8
R8301V	3P	R8401V	4P	on-none-on	R12	6 green		Contact Material
R8303V	3P	R8403V	4P	on-none-(on)	R22	7 blue		Q silver plated
R8305V	3P	R8405V	4P	on-off-on	P14	8 brown		R gold plated
R8307V	3P	R8407V	4P	(on)-off-(on)	P24	9 gray		G gold over silver
R8309V	3P	R8409V	4P	on-off-(on)				K tin-lead
3 way position switches				now the available is code "1/2/3/4/7/9" the other please inquiry first				
R818		SP3T	on-on-on					
R845V		DP3T	on-on-on					
				Epoxy seal				
				(none) none seal				
				E epoxy seal				
						support Bracket type		
						(none) std.		
						S snap-in type		

(A) **R 8 0 1 5 P** - **R 1 1** - **2** - **Q** - **E** - **S**

Horizon Right Angle	Vertical Right Angle	Switches Function	Actuator	Actuator Color	Contact Material	Epoxy seal
R8015P	R8015L / R8013L	SP on-none-on	R11	1 white	Q silver plated	(none) none seal
R8015PA	R8015LA / R8013LA	SP on-none-(on)	R21	2 black(std)	R gold plated	E epoxy seal
R8016P	R8016L / R8014L	SP on-off-on	P13	3 red	G gold over silver	support Bracket type
R8016PA	R8016LA / R8014LA	SP (on)-off-(on)	P23	4 orange	K tin-lead	
R8016PB	R8016LB / R8014LB	SP on-off-(on)	The right angle type cannot have frame.			(none) std.
R8017P	R8017L / R8011L	DP on-none-on	now the available is code "1/2/3/4/7/9" the other please inquiry first			S snap-in type
R8017PA	R8017LA / R8011LA	DP on-none-(on)				
R8018	R8018L / R8012L	DP on-off-on				
R8018PA	R8018LA / R8012LA	DP (on)-off-(on)				
R8018PB	R8018LB / R8012LB	DP on-off-(on)				
		R8301L				
		R8303L				
		R8305L				
		R8307L				
		R8309L				
		R8401L				
		R8403L				
		R8405L				
		R8407L				
		R8409L				
3 way position switches						
R818P/R818L/ R812L		SP3T on-on-on				
R845L		DP3T on-on-on				

SPDT

Model No.	Switching position		
R8015	ON	none	ON
R8015A	ON	none	(ON)
R8016	ON	OFF	ON
R8016A	(ON)	OFF	(ON)
R8016B	ON	OFF	(ON)
Term. Comm.	2-3	open	2-1

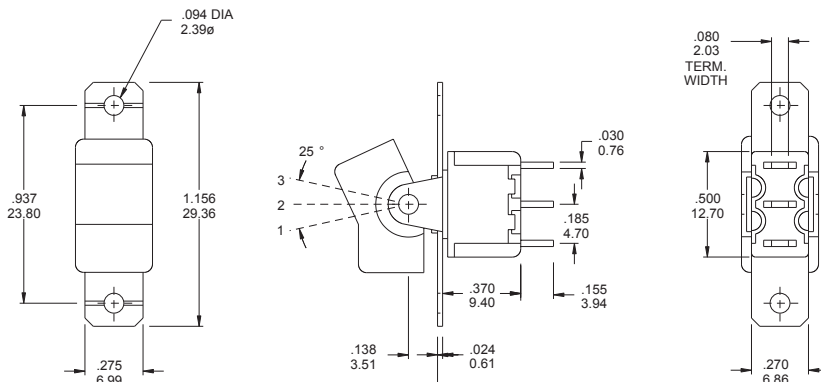
R8015 - R11-2-BQ
DPDT

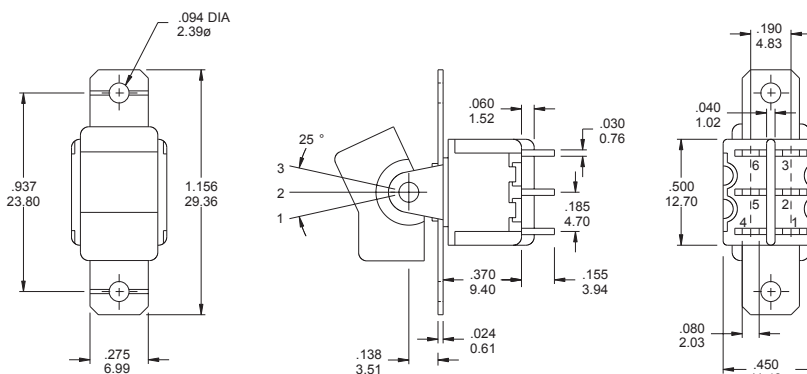

Model No.	Switching position		
R8017	ON	none	ON
R8017A	ON	none	(ON)
R8018	ON	OFF	ON
R8018A	(ON)	OFF	(ON)
R8018B	ON	OFF	(ON)
Term. Comm.	2-3,5-6	open	2-1,5-4
3 way switches (SP3T)			
R818	ON	ON	ON
Term. Comm.	2-3,5-6	2-3,5-4	2-1,5-4

R8017 - R11-2-BQ

Please see page B8 to know more about R818 (3-way Switches)

3PDT

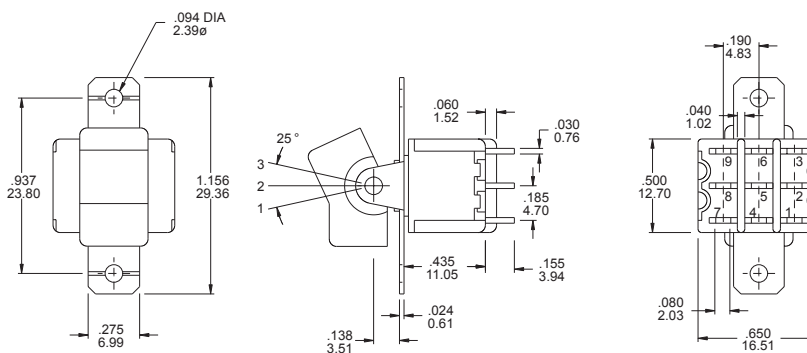
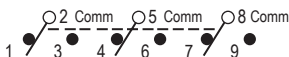
Model No.	Switching position		
R8301V	ON	none	ON
R8303V	ON	none	(ON)
R8305V	ON	OFF	ON
R8307V	(ON)	OFF	(ON)
R8309V	ON	OFF	(ON)
Term. Comm.	2-3,5-6 8-9	open	2-1,5-4 8-7

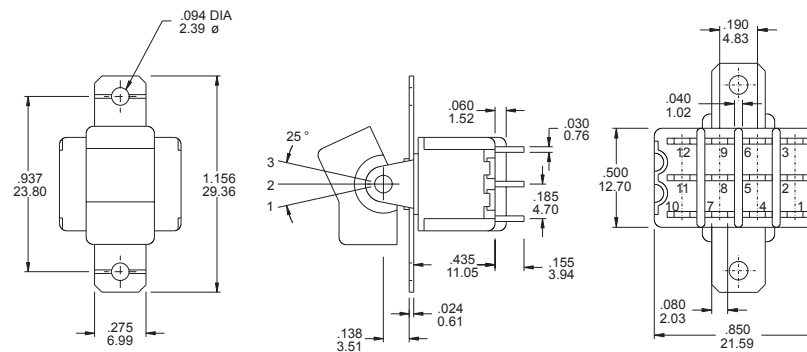

R8301V- R11-2-BQ
4PDT

Model No.	Switching position		
R8401V	ON	none	ON
R8403V	ON	none	(ON)
R8405V	ON	OFF	ON
R8407V	(ON)	OFF	(ON)
R8409V	ON	OFF	(ON)
Term. Comm.	2-3,5-6 8-9,11-12	open	2-1,5-4 8-7,11-10
3 way switches (DP3T)			
R845V	ON	ON	ON
Term. Comm.	2-3,5-6 8-9,11-12	2-3,5-4 8-9,11-10	2-1,5-4 8-7,11-10

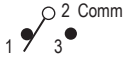

R8401V -R11-2-BQ

Please see page B8 to know more about R845V (3-way Switches)

B
2

**T80-R****Miniature Rocker and Paddle Switches (Right Angle Type)****HORISON RIGHT ANGLE****SPDT**

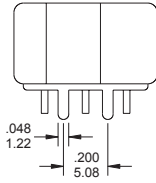
Model No.	Switching position		
R8015P	ON	none	ON
R8015PA	ON	none	(ON)
R8016	ON	OFF	ON
R8016PA	(ON)	OFF	(ON)
R8016PB	ON	OFF	(ON)
Term. Comm.	2-3	open	2-1



SWITCH SUPPORT

PIVOT

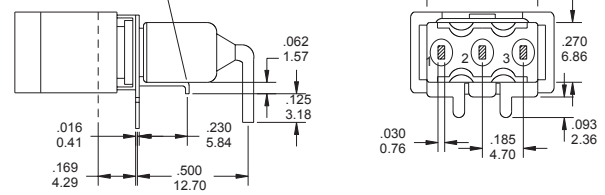
**R8015P- R11-2-Q****DPDT**

Model No.	Switching position		
R8017P	ON	none	ON
R8017PA	ON	none	(ON)
R8018P	ON	OFF	ON
R8018PA	(ON)	OFF	(ON)
R8018PB	ON	OFF	(ON)
Term. Comm.	2-3,5-6	open	2-1,5-4
3 way switches (SP3T)			
R818P	ON	ON	ON
Term. Comm.	2-3,5-6	2-3,5-4	2-1,5-4

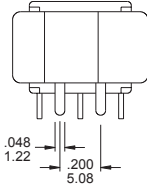

PIVOT

EPOXY SEAL

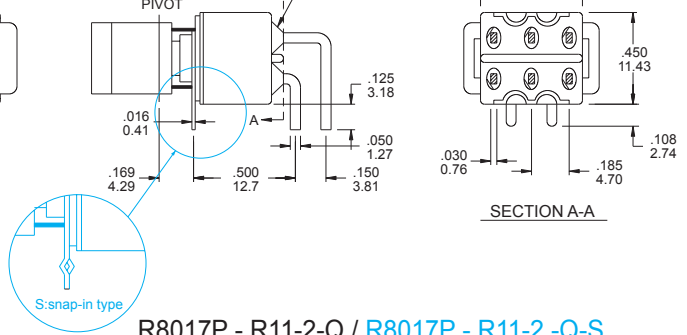
**R8017P - R11-2-Q / R8017P - R11-2-Q-S**

Please see page B-8 to know more about R818P □ (3-way Switches)

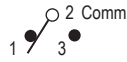
VERTICAL RIGHT ANGLE**SPDT**

Model No.	Switching position		
R8015L	ON	none	ON
R8015LA	ON	none	(ON)
R8016L	ON	OFF	ON
R8016LA	(ON)	OFF	(ON)
R8016LB	ON	OFF	(ON)
Term. Comm.	2-3	open	2-1

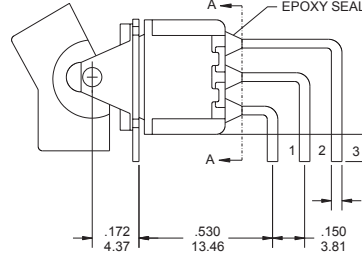
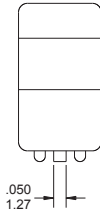
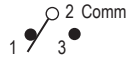
**R8015L - R11-2-Q****SPDT**

Model No.	Switching position		
R8013L	ON	none	ON
R8013LA	ON	none	(ON)
R8014L	ON	OFF	ON
R8014LA	(ON)	OFF	(ON)
R8014LB	ON	OFF	(ON)
Term. Comm.	2-3	open	2-1

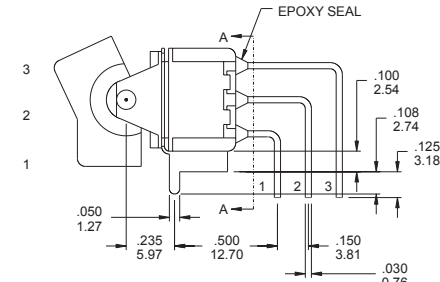
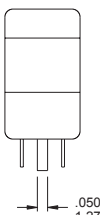
**R8013L- R11-2-Q****DPDT**

Model No.	Switching position		
R8017L	ON	none	ON
R8017LA	ON	none	(ON)
R8018L	ON	OFF	ON
R8018LA	(ON)	OFF	(ON)
R8018LB	ON	OFF	(ON)
Term. Comm.	2-3,5-6	open	2-1,5-4
3 way switches (SP3T)			
R818L	ON	ON	ON
Term. Comm.	2-3,5-6	2-3,5-4	2-1,5-4

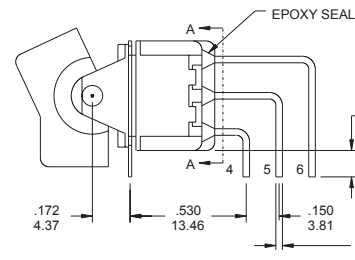
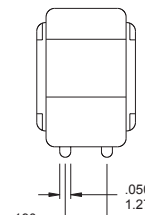
**R8017L - R11-2-Q**



VERTICAL RIGHT ANGLE PAGE

DPDT

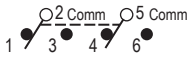

Model No.	Switching position		
R8011L	ON	none	ON
R011LA	ON	none	(ON)
R8012L	ON	OFF	ON
R8012LA	(ON)	OFF	(ON)
R8012LB	ON	OFF	(ON)
Term. Comm.	2-3,5-6	open	2-1,5-4
3 way switches (SP3T)			
R812L	ON	ON	ON
Term. Comm.	2-3,5-6	2-3,5-4	2-1,5-4

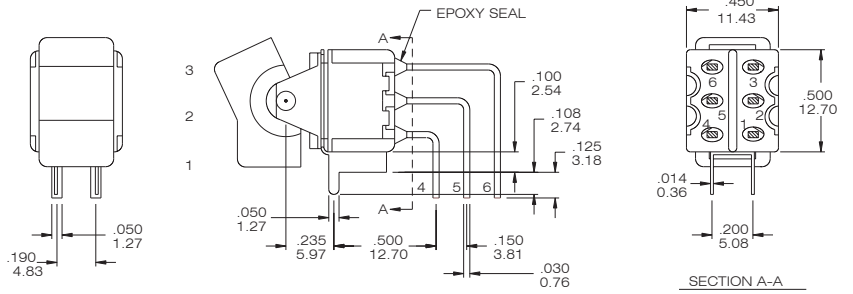

R8011L - R11-2-Q

Please see page B-8 to know more about R812L (3-way Switches)

3PDT

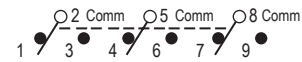

Model No.	Switching position		
R8301L	ON	none	ON
R8303L	ON	none	(ON)
R8305L	ON	OFF	ON
R8307L	(ON)	OFF	(ON)
R8309L	ON	OFF	(ON)
Term. Comm.	2-3,5-6 8-9	open	2-1,5-4 8-7

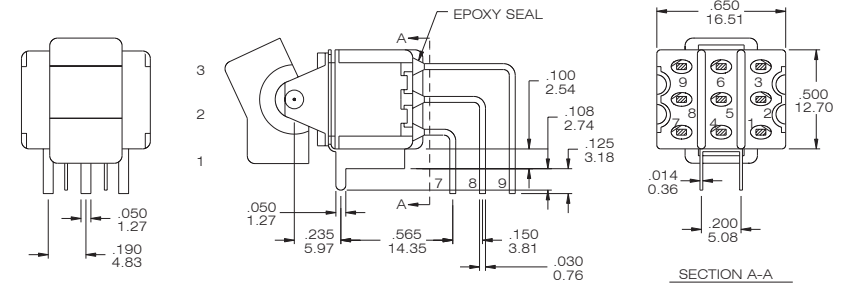

R8301L- R11-2-Q

4PDT



Model No.	Switching position		
R8401L	ON	none	ON
R8403L	ON	none	(ON)
R8405L	ON	OFF	ON
R8407L	(ON)	OFF	(ON)
R8409L	ON	OFF	(ON)
Term. Comm.	2-3,5-6 8-9,11-12	open	2-1,5-4 8-7,11-10
3 way switches (DP3T)			
R845L	ON	ON	ON
Term. Comm.	2-3,5-6 8-9,11-12	2-3,5-4 8-9,11-10	2-1,5-4 8-7,11-10

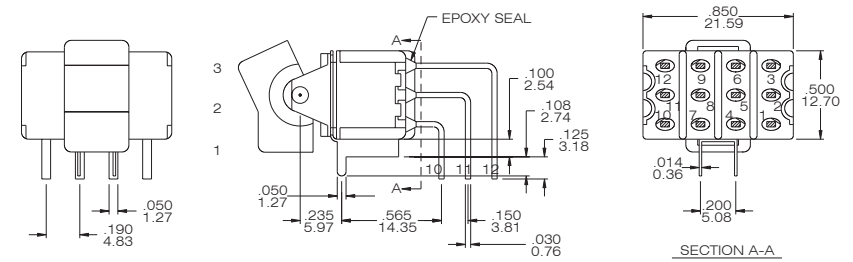

R8401L - R11-2-Q

Please see page B-8 to know more about R845L(3-way Switches)

FOR R8015P-T8016P

FOR R8017P-R8018P

FOR R8015L-R8016L

FOR R8013L-R8014L

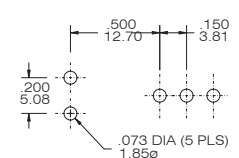
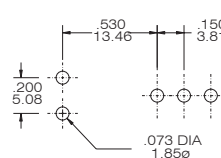
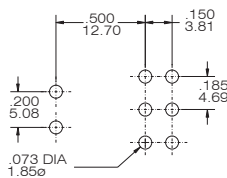
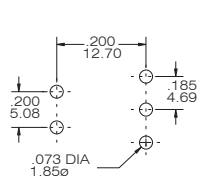

FOR R8017L-R8018L

FOR R8011L-R8012L

FOR R8301L-R8309L

FOR R8401L-R8409L

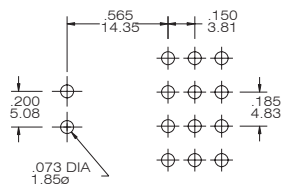
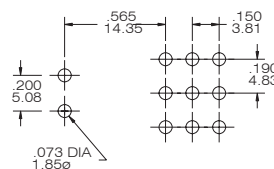
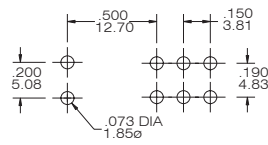
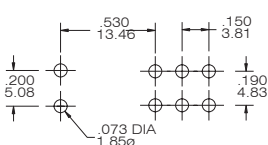



T80-R

Miniature Rocker and Paddle Switches

Actuator Option(PANEL REAR MOUNT) only for the straight type (Page B-2)

R11

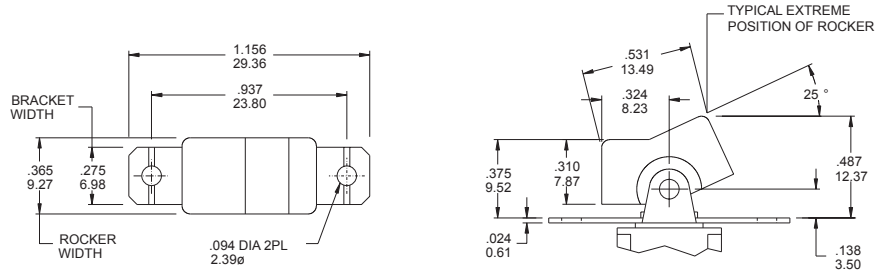

R21

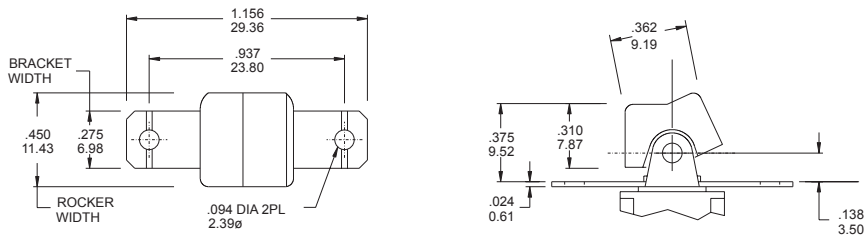

P13

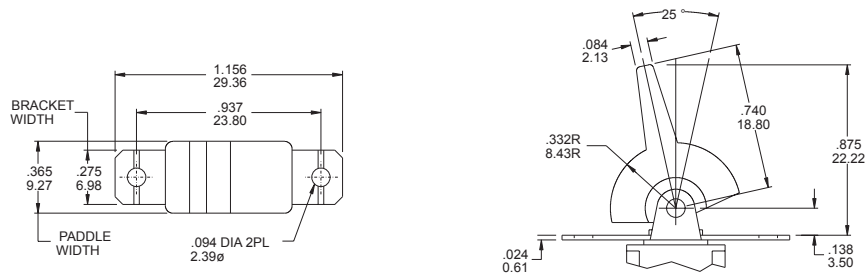

P23

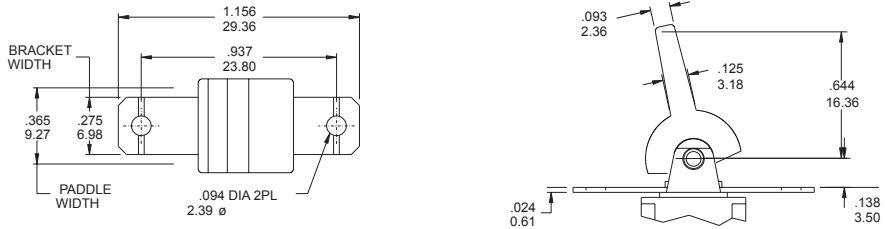

R15

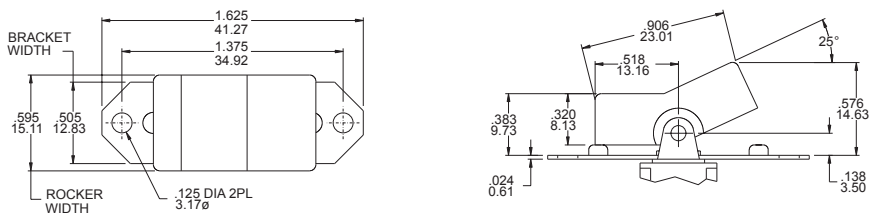

PANEL MOUNTING

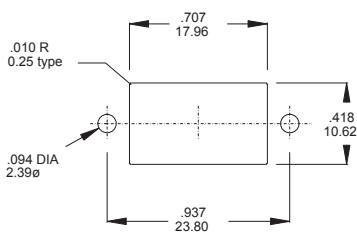

R11 / P13

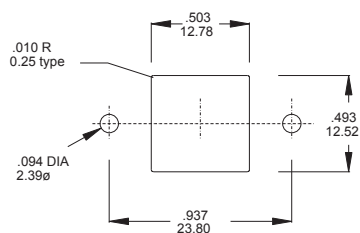

R21 / P23

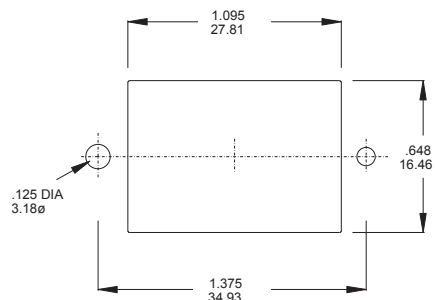

R15



T80-R

Miniature Rocker and Paddle Switches

Actuator Option(SNAP-IN FRONT MOUNT) only for the straight type (Page B-2)

R12

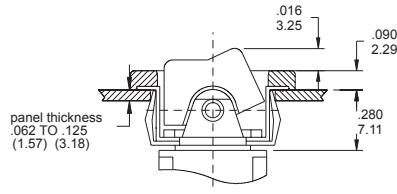
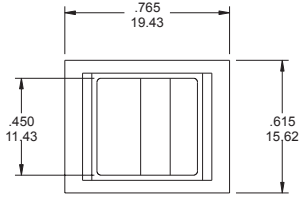

PANEL MOUNTING

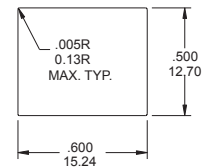

R22

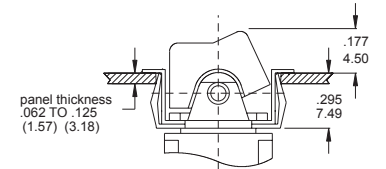
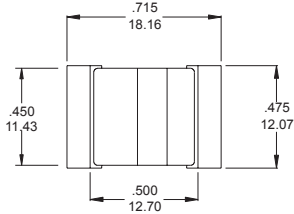

PANEL MOUNTING

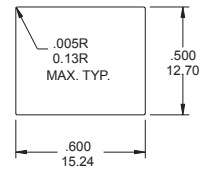

P14

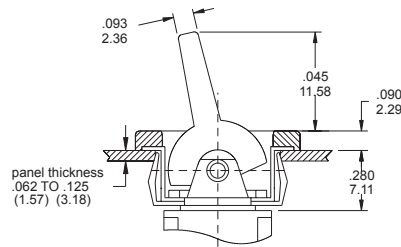
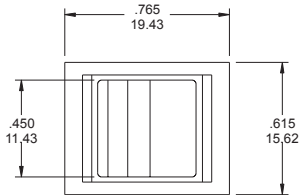

PANEL MOUNTING

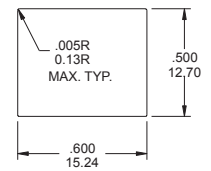

P24

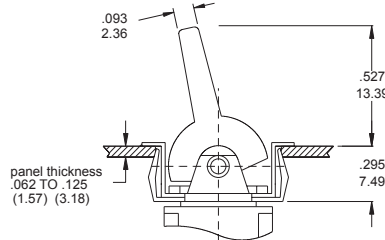
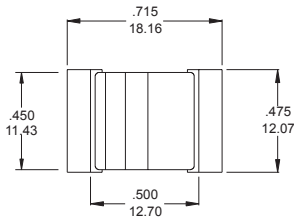

PANEL MOUNTING

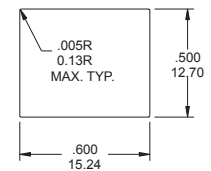

Actuator Option (P.C.B MOUNT)

R11

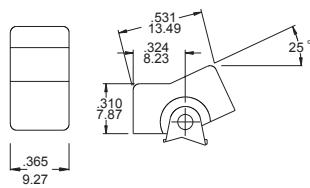

R21

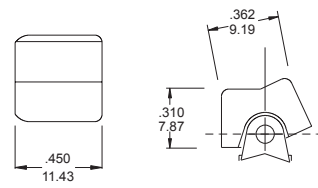

P13

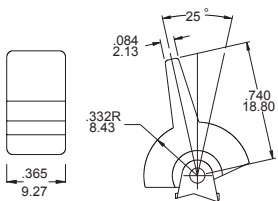
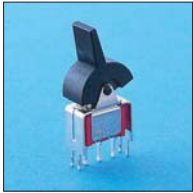

P23

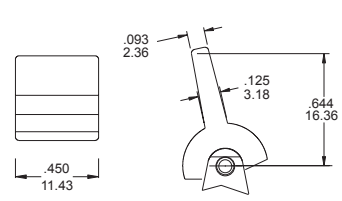
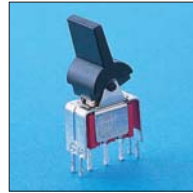

R15

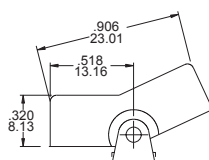
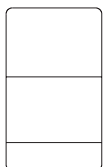

Actuator Color Option

ACTUATOR AND FRAME COLORS		
1 White	4 Orange	7 Blue
2 Black(Std.)	5 Yellow	8 Brown
3 Red	6 Green	9 Gray

B

6



T80-R

Miniature Rocker and Paddle Switches

TERMINAL OPTION (ONLY FOR THE STRAIGHT TYPE R8015~R8401)

TERMINAL SEAL OPTION

B SOLDER LUG

C PRINTED CIRCUIT

D QUICK CONNECT

WIREWRAP

E TERMINAL SEAL

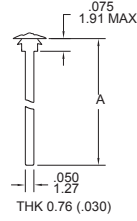
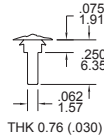
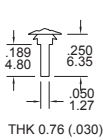
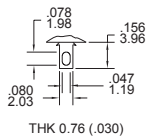

CODE	"A" dimension
D1	.750 (19.05)
D3	.425 (10.8)



CONTACT MATERIAL OPTIONS

CODE	CONTACT MATERIAL	TERMINAL MATERIAL	RATING
Q	Silver plated	Silver plated	5 A @ 120V AC or 28 V DC; 2 A @ 250 VAC
R	Gold plated over nickel plated	Gold plated over nickel plated	0.4VA MAX @ 20 V AC or DC MAX
G	Gold plated over silver plated	Gold plated over silver plated	0.4 VA MAX @ 20 V AC or DC MAX or 5 A @ 120V AC or 28 V DC; 2 A @ 250 VAC
K	Gold plated over nickel plated	Tin-lead over nickel plated	0.4VA MAX @ 20 V AC or DC MAX

* THE K option is only for some special item. Please inquiry first when you need the "K" option

VERTICAL SUPPORT BRACKET OPTION

(only apply the straight type terminal -page B 2. Please build the terminal option is "c" code)

S20 / S25/ V20/V25



SPDT

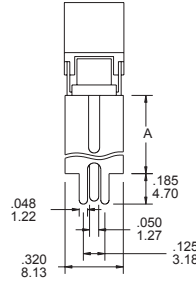
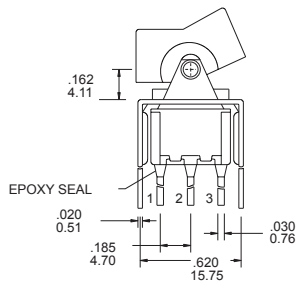

P.C. MOUNTING

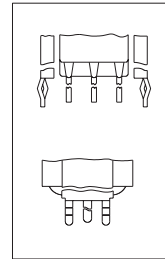
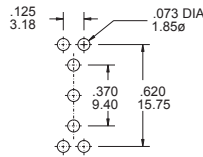

SNAP-IN
V20/ V25

R8015-R11-2-CQ-S20(S25)

DPDT

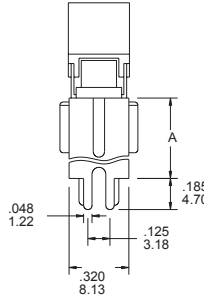
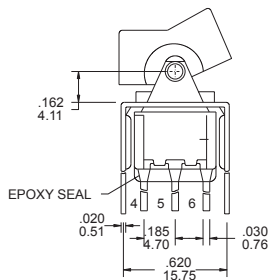

P.C. MOUNTING

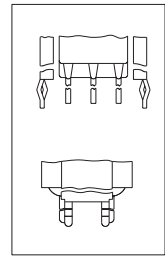
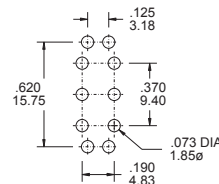

SNAP-IN
V20/ V25

R8017 - R11-2-CQ-S20(S25)

S35/S40 /V35/V40



SPDT

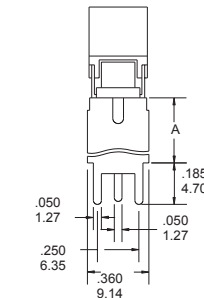
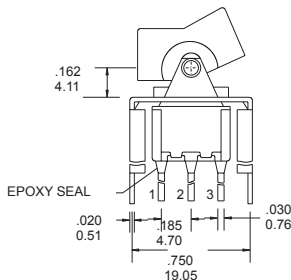

P.C. MOUNTING

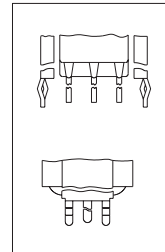
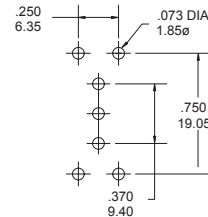

SNAP-IN
V35/ V40

R8015-R11-2-CQ-S35(S40)

B
7



T80-R

Miniature Rocker and Paddle Switches

option Code	A dimension
S35/V35	.460 11.68
S40/V40	.630 16.00
V35/V40 : the snap-in type	

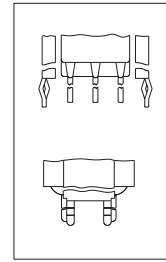
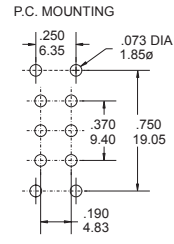
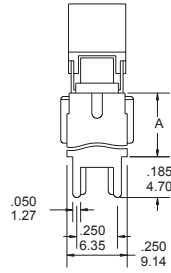
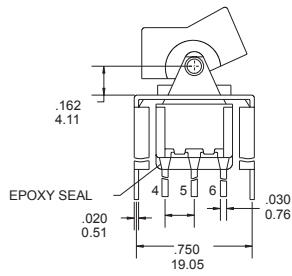

SNAP-IN
V35/ V40

R8015-R11-2-CQ-S35(S40)

The information of 3-way toggle switches

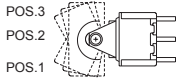

SINGLE POLE, 3 POSITION

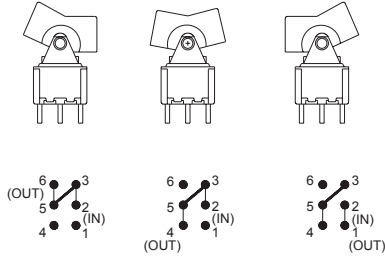

SP3T

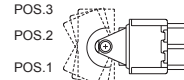

SINGLE POLE, 3 POSITION

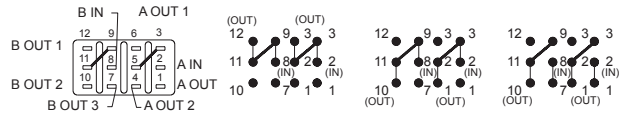

DP3T