



The A-0702 Series Circuit Protectors use a snap-acting bi-metal element to sense overload. They are compact and moderately priced making them extremely suited for commercial and appliance applications.

Other features include:

- Vibration Resistant.
- No contact chatter.
- Trip-free mechanism.
- Visual trip indication.

**SPECIFICATIONS**

**Calibration:**

- 25°C - 100% of Rated Current-continuously carried.
- 25°C - between 101% to 170%-May trip or not.
- 25°C - 175% of Rated Current - Trip within 1 hour.
- 25°C - 200% of Rated Current - Trip within 1 minute.

**Standard Ratings:**

- 1-20 ampere.

**Input Power:**

- 12VDC/125VAC/250VAC.

**Dielectric Strength:**

- 1500VAC/1 minute.

**Rated Conditional Short-Circuit Current:**

- IEC-934  
"PC. 1 1000A" with "Fuse 16A gL/gG".

**Insulation Resistance:**

- > 100 MΩ.

**Contact Endurance:**

- 125VAC x 150% of Rated Current - 500 cycles.

**IEC-934 Method of Operation:**

- "R" = Automatic interruption and non-automatic (manual) resetting.

**IEC-934 Method of Tripping:**

- "TO" = Thermal.

**Degree of Trip-Free Behaviour:**

- "Cycling trip-free".

**APPROVALS**

U L Approval: 1 - 15A 125VAC, 5 - 16A 12VDC

CSA Approval: 2 - 15A 125VAC

VDE Approval: 2 - 16A 250VAC

**APPLICATIONS**

- Table Saw
- Battery Charger
- Generator
- Screw Driver

MAX. Internal Resistance	
1.0A-2.0A	0.500Ω
2.1A-2.5A	0.320Ω
2.6A-3.0A	0.180Ω
3.1A-4.0A	0.100Ω
4.1A-6.0A	0.050Ω
6.1A-9.0A	0.020Ω
9.1A-12A	0.016Ω
12.1A-16A	0.012Ω
16.1A-20A	0.012Ω

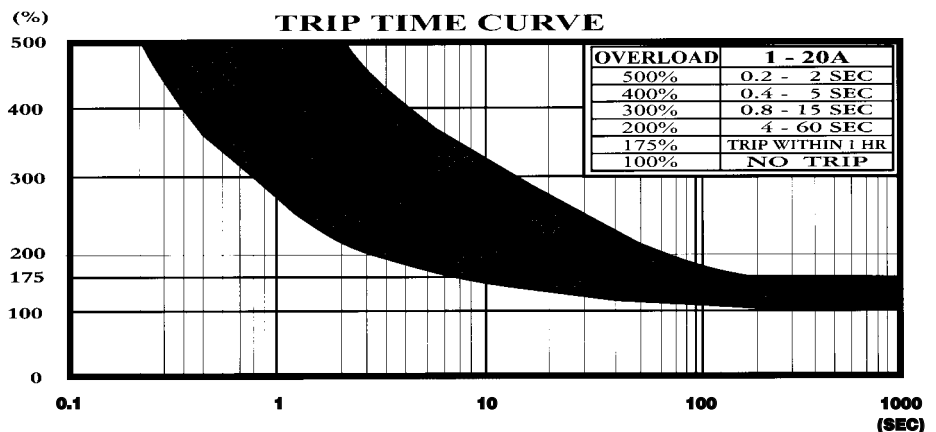
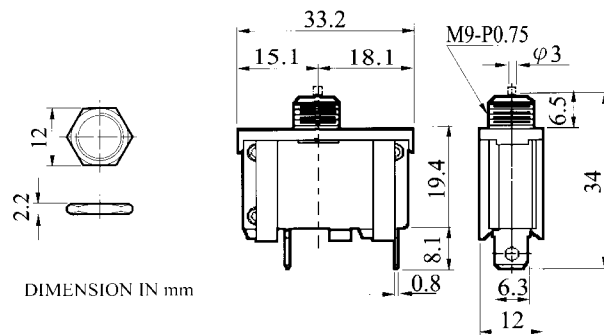

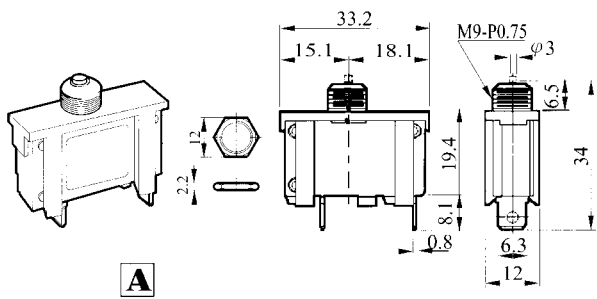

**A**

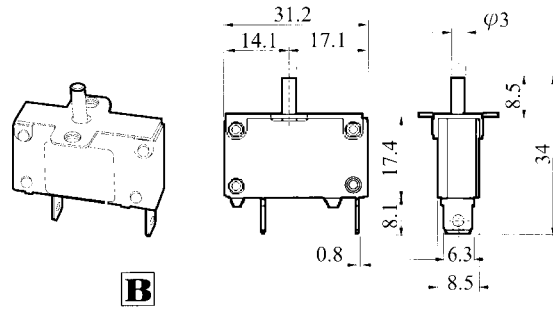

**B**

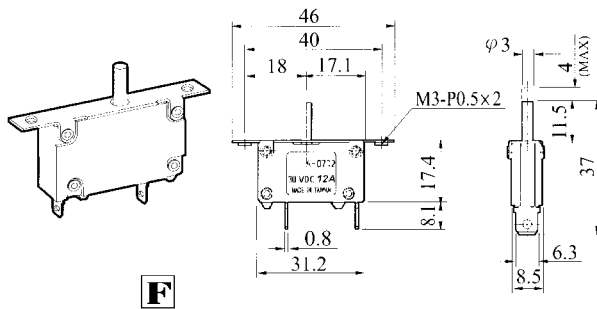

**F**

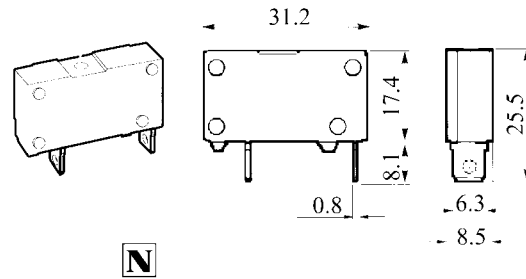

**N**

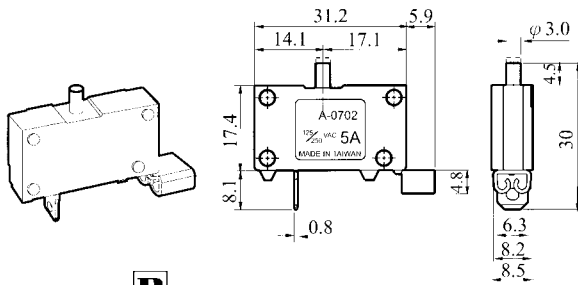

**P**

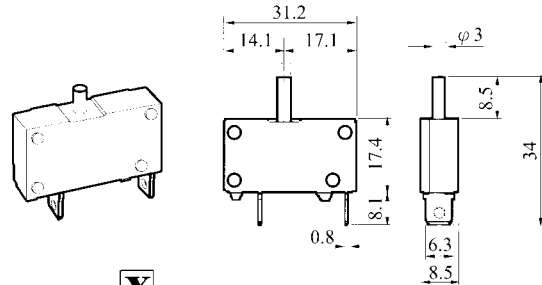

**X**

**ORDERING INFORMATION**

**A 0 7 0 2**

Series

**A**

Breaker Style

A, B, F,  
N, P, X

**1 0**

Rating

1 - 20